

converge Transmitter Quick Start Guide

For other non-computer connections. See pages 8-9 in the Users Manual.

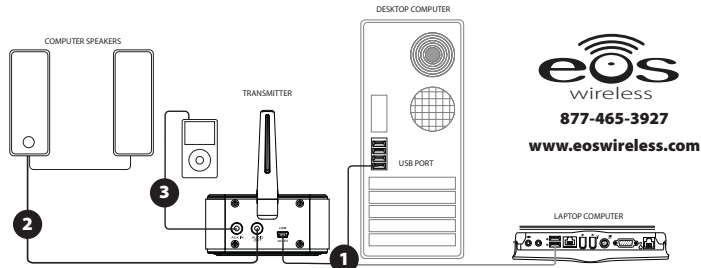

eos
wireless
877-465-3927
www.eoswireless.com

Connection

1 Connect USB

Using the included USB cable, plug one end into the Converge Transmitter and the other end into an available USB port on your desktop or laptop computer. (Audio input and power to the Converge Transmitter are supplied through the USB port -- no additional cabling or external power is required.)

2 Connect Powered Speakers

Powered multi-media/computer speakers can be connected to the Converge Transmitter by plugging in the stereo jack from the speakers into the jack labeled AUDIO OUT.

3 Connect Aux Audio Source (not required)

An auxiliary audio source may also be connected by plugging in the supplied stereo headphone cable to the jack on the Converge Transmitter marked AUX IN. The other end of the cable can be connected to the headphone jack of any external audio device. You may toggle between inputs by pressing the SOURCE button located on the top of the Converge Transmitter.

4 Power On

Press the POWER button located on the top of the transmitter. Transmitter is powered on when LED lights are illuminated

Settings

Windows Users

1 Open the Control Panel from the "Start" menu and select "Sounds and Audio Devices."

2 Under the "Audio" tab, choose "Converge USB TX" for "Sound Playback."

3 Set PC's Volume level to the Maximum Output Level.

Your PC's sound will now be output through the Converge Transmitter as well as the AUDIO OUT jack.

NOTE: If no sound is output, restart iTunes or other software based audio playback program (like Windows Media Player, Real Player...). If using web based internet radio like Pandora, Last FM, YouTube... reload your the web page that is playing the audio content.

Macintosh Users

1 Open System Preferences and select "Sound" and Click on the "Output" tab.

2 Under the "Output" tab, select "Converge USB TX."

3 Set Mac's Volume level to the Maximum Output Level.

Your Mac's sound will now be output through the Converge Transmitter as well as the AUDIO OUT jack.

IMPORTANT - Set the computer or external audio device's Volume output to maximum level.

Operation

Transmitting Computer Audio

1 Launch the audio application on your computer.

2 Set the application's Volume level to the Maximum Output Level.

3 Select the play function from within the application.

Note: the Eos Converge Transmitter will transmit any audio played on any system application including, but not limited to iTunes, Windows Media Player, Real Player, Internet radio stations like Pandora, Rhapsody & Last FM...

Transmitting External Audio

1 Using the Source Button, select AUX (AUX LED will illuminate).

2 Set Volume level to the Maximum Output Level.

3 Press PLAY on the external audio device.

converge Receiver Quick Start Guide

Amplified Receiver Connection



877-465-3927

www.eoswireless.com

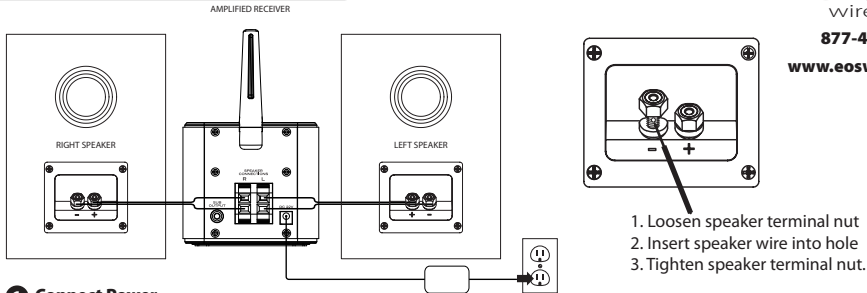

1 Connect Power

- Plug the included power adapter into a wall outlet and the other end into the receiver jack marked "22V DC"
- Press volume knob to turn on power (antenna LED will illuminate)

2 Connect Speakers Wires (Amplified Receiver)

- Using the provided speaker cables, use your thumb or fingers and press the spring-loaded terminal tab to open the connection hole. Once the stripped portion of the wire is securely in the hole, release the terminal tab

3 Connect Speakers Wires (Eos Loudspeakers)

- Use your fingers loosen the screw terminals to reveal the connection hole (turn counter clockwise to loosen).
- Insert the stripped end of gold colored wire to the speaker terminal hole marked "+" (red). Insert the stripped end of silver colored wire to the speaker terminal hole marked "-" (black)
- Use your fingers tighten the screw terminal to secure wires into the speaker terminal hole (turn counter clockwise to tighten).

Line In Receiver Connection

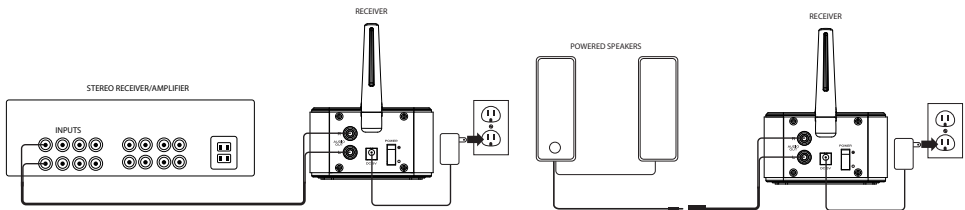

1 Connect Power

- Plug the included power adapter into a wall outlet and the other end into the receiver jack marked "5V DC"
- Toggle power switch to ON position (antenna LED will illuminate)

2 Connect Stereo Receiver/Amplifier

- Using the provided RCA to RCA stereo cable, connect cable to the rear of the Converge Wireless Receiver unit marked AUDIO out. Connect the other end of the cable into any available audio input jack of your main home audio system receiver.
- Using your home stereo receiver's input selector switch, select the input that you connected the Converge Wireless Receiver into. When selected, audio from the Converge Transmitter will play from your home stereo system's receiver. Adjust volume level from the stereo receiver.

OR

2 Connect Stereo Amplified Speakers

- Using the provided "Y" cable, connect RCA cables to the rear of the Converge Wireless Receiver unit marked AUDIO out.
- Plug the cable from the powered speakers into the jack on the end of the "Y" cable.
- Turn the powered speakers ON and audio from the Converge Transmitter will begin playing. Adjust the sound level from the powered speakers volume control.